

## Handling instruction manual cap opener for the berlinger® *lausanne*KIT

1. Open the handle.

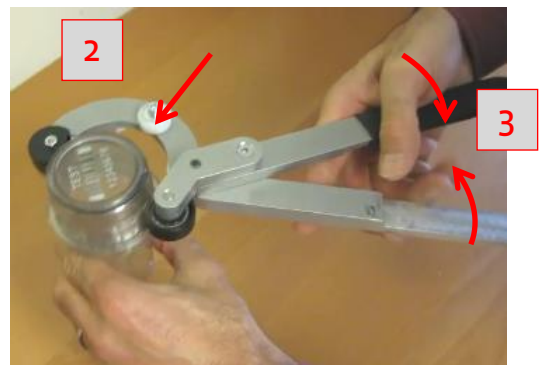

2. Place the cap opener onto the sealed bottle neck.



3. Close the two handles and keep them closed with one hand.

4. Important:  
The cutting wheel must be placed on the rim of the cap.



5. Lift the opener with the kit and turn the kit with the free hand in a clockwise direction.



**Information:**  
Two revolutions will be enough. During this process the cap will be cut and separated. You can hear a little noise when the knives cut the plastic.

6. Open the handle again.

7. Take out the kit.

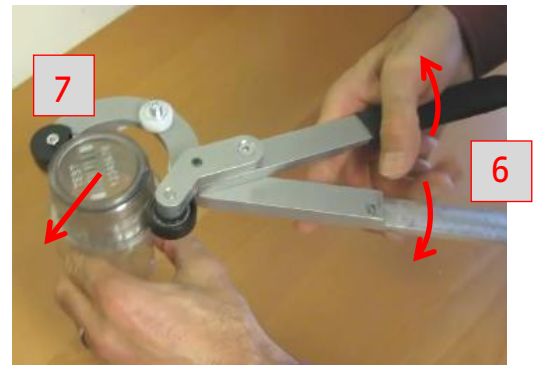

8. Close the handle again.



9. The indentation on the underside of the tool is used as a help to open the cap of the kit.

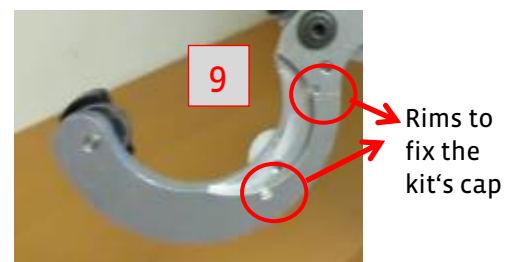

10. Place the top of the cap into the inlet.



11. Turn the kit in an anti-clockwise direction and keep the tool calm and firmly.



12. While turning the pressure releases and the cap can now be opened manually.



➤ Step by step with video (up on request).